

Infinity Header Installation - FXF2 Fixtures



Carefully read the contents of these instructions, as the instructions indicate the correct step by step procedure to assemble the product. In the event of assembly problems or missing parts, please call our customer service department at 616-842-5330.

CAUTION:

ASSEMBLED UNIT IS VERY HEAVY. DO NOT ATTEMPT TO LIFT OR MOVE WITHOUT ASSISTANCE.

THE MANUFACTURER OF THIS DISPLAY ASSUMES NO LIABILITY FOR INJURY CAUSED BY IMPROPER ASSEMBLY / INSTALLATION OF THIS DISPLAY.



WARNING:

This product contains chemicals known to the State of California to cause cancer and birth defects or other reproduction harm.

For more information, go to www.P65Warnings.ca.gov

NUMBER OF PEOPLE REQUIRED TO ASSEMBLE:1
ESTIMATED TIME: 1 hour

TOOLS:

- Flathead screwdriver
- Power driver

305703IS

09-23-2020

**IT IS THE RESPONSIBILITY OF THE INSTALLER TO CAREFULLY READ & FOLLOW ALL STEPS IN THE INSTRUCTIONS.

SHEET 1 OF 4

HARBOR

Infinity Header Installation - FXF2 Fixtures

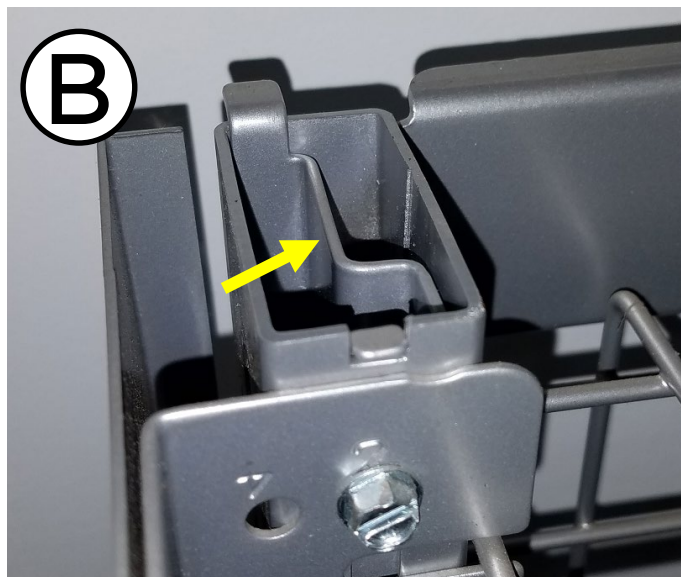
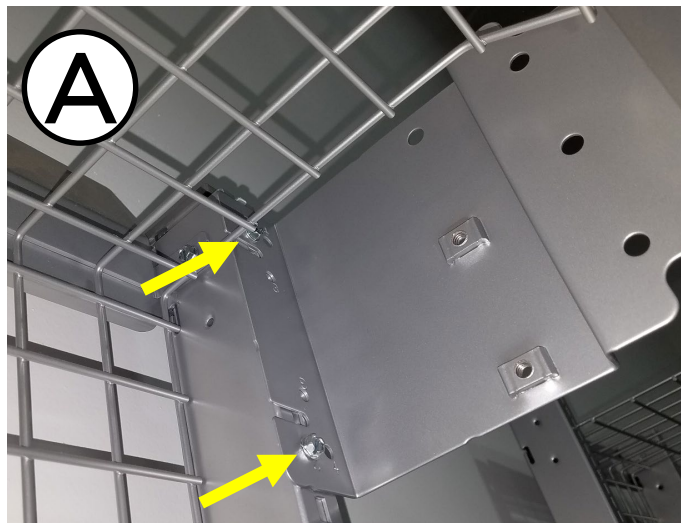

1. Remove the old FXF2 Header.

A - Remove the old FXF2 header by unbolting it from the slotted uprights. To unbolt the LH and RH header brackets remove the (2) bolts located on the inside flange of the brackets.

B - The insert bracket located on the inside of the slotted upright can be left in place.

305703IS

09-23-2020

**IT IS THE RESPONSIBILITY OF THE INSTALLER TO CAREFULLY READ & FOLLOW ALL STEPS IN THE INSTRUCTIONS.

HARBOR

Infinity Header Installation - FXF2 Fixtures

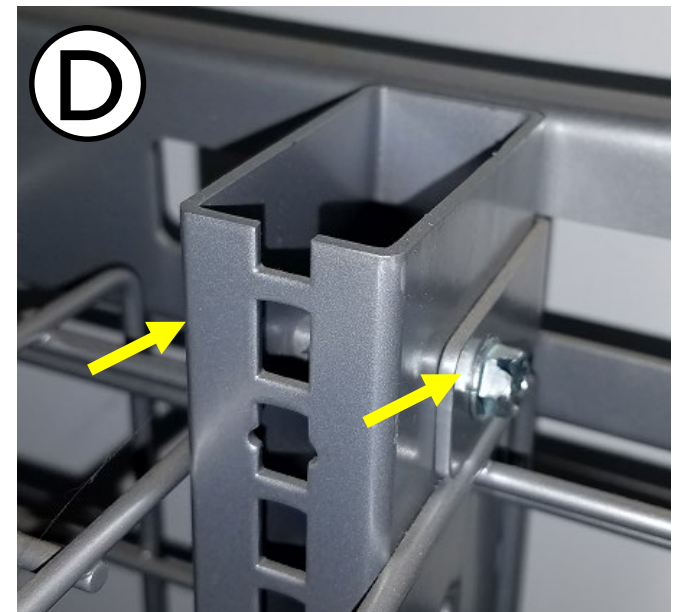

2. Remove the FXF2 Wire Grid.

C - OPTION 1: Remove the top wire grids from the FXF2 fixture by cutting all of the horizontal wires down the middle and then pulling the 2 halves out.

D - OPTION 2: Unbolt and remove the top crossbar from the slotted uprights and then lift the top wire grids out of the uprights. Make sure to replace the top crossbar.

305703IS

09-23-2020

**IT IS THE RESPONSIBILITY OF THE INSTALLER TO CAREFULLY READ & FOLLOW ALL STEPS IN THE INSTRUCTIONS.

Infinity Header Installation - FXF2 Fixtures



3 - Install The New Infinity Header.

E -Once the wire grids are removed from the FXF2 fixture, install the new Infinity header per the instructions provided with the header.

Note - The new Infinity header will need an additional row of 1' shelves to mount to, that are not provided with the new header. They may need to be ordered separately.

Note - Once installed, the graphics on the new Infinity header should align with the graphics on any adjacent FXF2 headers.



305703IS

09-23-2020

**IT IS THE RESPONSIBILITY OF THE INSTALLER TO CAREFULLY READ & FOLLOW ALL STEPS IN THE INSTRUCTIONS.

HARBOR